

**NEW**

MRAブランドから新たにERコレットシステムをラインナップ!! The MRA brand now offers a new ER collet system!

**高精度のUP級で品揃え、芯振れ精度は5μm以内**

This lineup of high precision UP-grade collets boasts a center runout accuracy of 5 μm or less

**高精度**  
UP級でのラインナップ  
High precision  
UP-grade collets

**高品質**  
信頼のMRAブランド  
High quality  
The trusted MRA brand

**経済的**  
標準級価格でご提供  
Economical Offered at  
standard-grade prices



**UP級**  
UP-grade

## ER スプリングコレット

ER spring collets

## 高精度のUP級コレット

High precision UP-grade collets



ER8

ER11~32

MRA ERコレットは、すべてUP級で揃えており、芯振れ精度は5μm以内の高精度です。

ヨーロッパで標準の16°テーパコレット(片角8°) DIN6499/ISO15488。コレットサイズはER8、ER11、ER16、ER20、ER25、ER32の6種類。

All MRA ER collets are UP-grade products, and boast a center runout accuracy of 5μm or less.

Europe-standard 16° taper collets (8° single angle) meet DIN6499/ISO15488 standards.

Six collet sizes are available: ER8, ER11, ER16, ER20, ER25, and ER32.

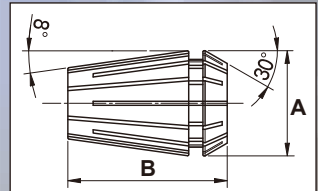

品番 Part no.	チャッキング範囲 Chuckling range (mm)	外径 Outer diameter A	長さ Length B	品番 Part no.	チャッキング範囲 Chuckling range (mm)	外径 Outer diameter A	長さ Length B	品番 Part no.	チャッキング範囲 Chuckling range (mm)	外径 Outer diameter A	長さ Length B				
ER 8				MRA-ERC16.0300	2.0~3.0			MRA-ERC25.0800	7.0~8.0						
MRA-ERC08.0100	0.5~1.0	8.5	13.5	MRA-ERC16.0400	3.0~4.0	17	27.5	MRA-ERC25.0900	8.0~9.0	26	34				
MRA-ERC08.0150	1.0~1.5			MRA-ERC16.0500	4.0~5.0			MRA-ERC25.1000	9.0~10.0						
MRA-ERC08.0200	1.5~2.0			MRA-ERC16.0600	5.0~6.0			MRA-ERC25.1100	10.0~11.0						
MRA-ERC08.0250	2.0~2.5			MRA-ERC16.0700	6.0~7.0			MRA-ERC25.1200	11.0~12.0						
MRA-ERC08.0300	2.5~3.0			MRA-ERC16.0800	7.0~8.0			MRA-ERC25.1300	12.0~13.0						
MRA-ERC08.0350	3.0~3.5			MRA-ERC16.0900	8.0~9.0			MRA-ERC25.1400	13.0~14.0						
MRA-ERC08.0400	3.5~4.0			MRA-ERC16.1000	9.0~10.0			MRA-ERC25.1500	14.0~15.0						
MRA-ERC08.0450	4.0~4.5			ER 20				MRA-ERC25.1600	15.0~16.0						
MRA-ERC08.0500	4.5~5.0			MRA-ERC20.0200	1.5~2.0			ER 32							
ER 11								MRA-ERC20.0300	2.0~3.0					MRA-ERC32.0300	2.0~3.0
MRA-ERC11.0100	0.5~1.0	11.5	18	MRA-ERC20.0400	3.0~4.0	21	31.5	MRA-ERC32.0400	3.0~4.0	33	40				
MRA-ERC11.0150	1.0~1.5			MRA-ERC20.0500	4.0~5.0			MRA-ERC32.0500	4.0~5.0						
MRA-ERC11.0200	1.5~2.0			MRA-ERC20.0600	5.0~6.0			MRA-ERC32.0600	5.0~6.0						
MRA-ERC11.0250	2.0~2.5			MRA-ERC20.0700	6.0~7.0			MRA-ERC32.0700	6.0~7.0						
MRA-ERC11.0300	2.5~3.0			MRA-ERC20.0800	7.0~8.0			MRA-ERC32.0800	7.0~8.0						
MRA-ERC11.0350	3.0~3.5			MRA-ERC20.0900	8.0~9.0			MRA-ERC32.0900	8.0~9.0						
MRA-ERC11.0400	3.5~4.0			MRA-ERC20.1000	9.0~10.0			MRA-ERC32.1000	9.0~10.0						
MRA-ERC11.0450	4.0~4.5			MRA-ERC20.1100	10.0~11.0			MRA-ERC32.1100	10.0~11.0						
MRA-ERC11.0500	4.5~5.0			MRA-ERC20.1200	11.0~12.0			MRA-ERC32.1200	11.0~12.0						
MRA-ERC11.0550	5.0~5.5			MRA-ERC20.1300	12.0~13.0			MRA-ERC32.1300	12.0~13.0						
MRA-ERC11.0600	5.5~6.0			ER 25				MRA-ERC32.1400	13.0~14.0						
MRA-ERC11.0650	6.0~6.5			MRA-ERC25.0200	1.5~2.0			MRA-ERC32.1500	14.0~15.0						
MRA-ERC11.0700	6.5~7.0			MRA-ERC25.0300	2.0~3.0			MRA-ERC32.1600	15.0~16.0						
ER 16								MRA-ERC25.0400	3.0~4.0			26	34	MRA-ERC32.1700	16.0~17.0
MRA-ERC16.0100	0.5~1.0			MRA-ERC25.0500	4.0~5.0			MRA-ERC32.1800	17.0~18.0						
MRA-ERC16.0150	1.0~1.5			MRA-ERC25.0600	5.0~6.0			MRA-ERC32.1900	18.0~19.0						
MRA-ERC16.0200	1.5~2.0	MRA-ERC25.0700	6.0~7.0	MRA-ERC32.2000	19.0~20.0										

# ストレートシャンク コレットチャク(超スリムタイプ) Straight shank collet chucks (ultra-slim type)

深く狭い箇所の干渉を避けたい加工にご使用ください。  
Ideal to avoid interference when machining deep and narrow areas.

## ●ホルダー Holders

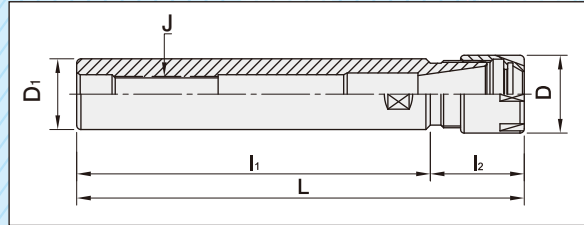
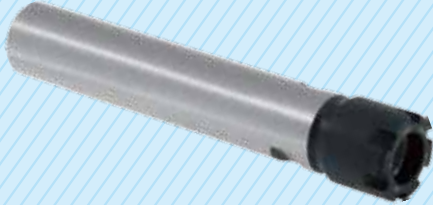

品番 Part no.	コレット タイプ Collet type	チャッキング範囲 Chucking range (mm)	シャンク径 Shank diameter D <sub>1</sub> (mm)	シャンク長 Shank length L <sub>1</sub> (mm)	l <sub>2</sub> (mm)	全長 Total length L (mm)	ナット外径 Nut outer diameter D (mm)	調整ネジ Adjustment screw J	質量 Mass (kg)
MRA-ERH08.101000	ER 8	0.5~5.0	10	100	16.2	116.2	12	-	0.062
MRA-ERH11.161000	ER 11	0.5~7.0	16	100	16.6	116.6	16	M5×0.8	0.132
MRA-ERH11.161400				140		156.6			0.184
MRA-ERH16.201000	ER 16	0.5~10.0	20	100	26.6	126.6	22	M10×1.5	0.208
MRA-ERH16.201600				160		186.6			0.310
MRA-ERH20.201000	ER 20	1.5~13.0	20	100	40	140	28	M12×1.75	0.224
MRA-ERH20.201800				180		220			0.340

## ●コレット ナット Collet nuts

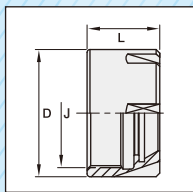

品番 Part no.	D (mm)	L (mm)	J	質量 Mass (kg)
MRA-ERN08M	12	10.8	M10×0.75	0.003
MRA-ERN11M	16	11.3	M13×0.75	0.006
MRA-ERN16M	22	18.0	M19×1.0	0.016
MRA-ERN20M	28	19.0	M24×1.0	0.028

## ●レンチ Wrenches

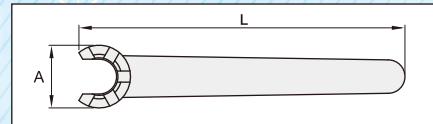

品番 Part no.	A (mm)	L (mm)	質量 Mass (kg)
MRA-ERR08M	13	75	0.014
MRA-ERR11M	17	95	0.028
MRA-ERR16M	23	117	0.046
MRA-ERR20M	29	129	0.062

## ●セット品 Sets

品番 Part no.	コレット タイプ Collet type	ホルダー Holder	コレット Collets	レンチ Wrench
MRA-ERS08.1000-3	ER 8	MRA-ERH08.101000	Φ2.0,3.0,4.0	MRA-ERR08M
MRA-ERS11.1000-5	ER 11	MRA-ERH11.161000	Φ2.0,3.0,4.0 6.0,7.0	MRA-ERR11M
MRA-ERS11.1400-5		MRA-ERH11.161400		
MRA-ERS16.1000-5	ER 16	MRA-ERH16.201000	Φ3.0,4.0,6.0 8.0,10.0	MRA-ERR16M
MRA-ERS16.1600-5		MRA-ERH16.201600		
MRA-ERS20.1000-5	ER 20	MRA-ERH20.201000	Φ4.0,6.0,8.0 10.0,12.0	MRA-ERR20M
MRA-ERS20.1800-5		MRA-ERH20.201800		



総販売元  
General distributor



株式会社 **ムラキ** 機械工具部  
**MURAKI Ltd.**  
Machine Tool Div.

Website: <http://www.muraki-ltd.co.jp>

〒103-0027 東京都中央区日本橋3-9-10  
〒542-0081 大阪市中央区南船場1-16-20  
〒461-0001 名古屋市中区東1-20-4  
〒812-0013 福岡市博多区博多駅東2-18-23 1階

Nihonbashi 3-9-10, Chuo-ku, Tokyo 103-0027  
Minami-senba 1-16-20, Chuo-ku, Osaka-shi, Osaka Metropolitan Area, 542-0081  
Izumino 1-20-4, Higashi-ku, Nagoya-shi, Aichi 461-0001  
IWASE BLD. 1F, Hakataeki-higashi, Hakata-ku, Fukuoka-shi, Fukuoka 812-0013

☎(03)3273-7511(代) FAX (03)3281-2243  
☎(06)6262-5923(代) FAX (06)6262-5927  
☎(052)962-3336(代) FAX (052)962-3339  
☎(092)474-4030(代) FAX (092)474-4054

Tel:+81-3-3273-7511 Fax:+81-3-3281-2243  
Tel:+81-6-6262-5923 Fax:+81-6-6262-5927  
Tel:+81-5-2962-3336 Fax:+81-5-2962-3339  
Tel:+81-9-2474-4030 Fax:+81-9-2474-4054