

SCHAUBLIN COLLET D 12

INTERCHANGEABLE ARBORS  
ISO-BT-HSK

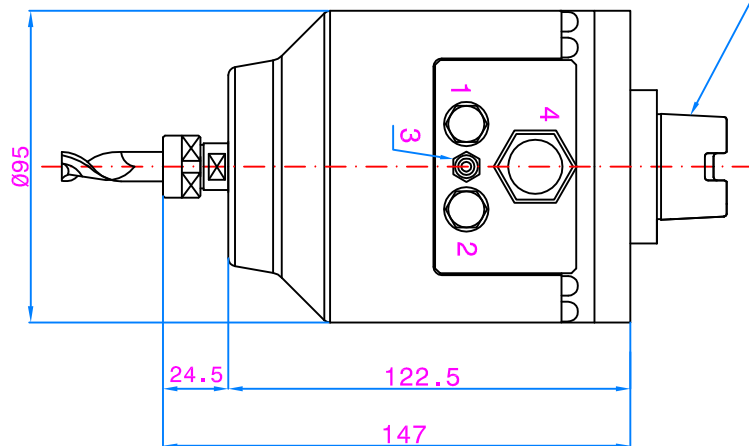

- 1-Cooling inlet (G 1/8")
  - 2-Cooling outlet (G 1/8")
  - 3-Front pressurisation (M6)
  - 4-Electric connection
- Motor phases - Earth - Sensor NC

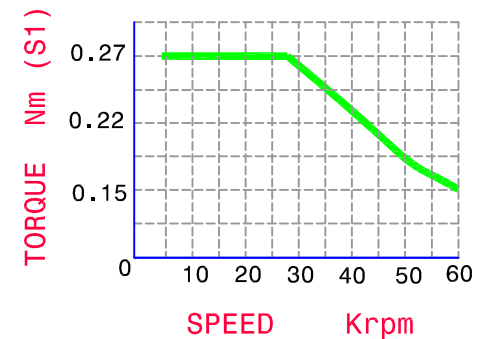
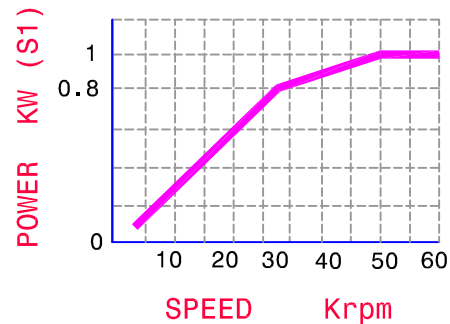

- Asynchronous motor 2 poles
- Max power 1.6 Kw
- Max torque 0.3 Nm
- Tension 220 V
- Max current 5 A
- Max frequency 1000 Hz
- N°1 Ø 15 front hybrid ceramic bearing
- Bearings's lubrication by permanent grease
- Manual clamping tools
- Autonomous cooling and internal liquid circuit
- Required cooling capacity 800 Watt
- Weight Kg 3.5



SUBJECT: PS-A-1  
CUSTOMER:

SHEET : 1/1

DATE : 22/12/2008